

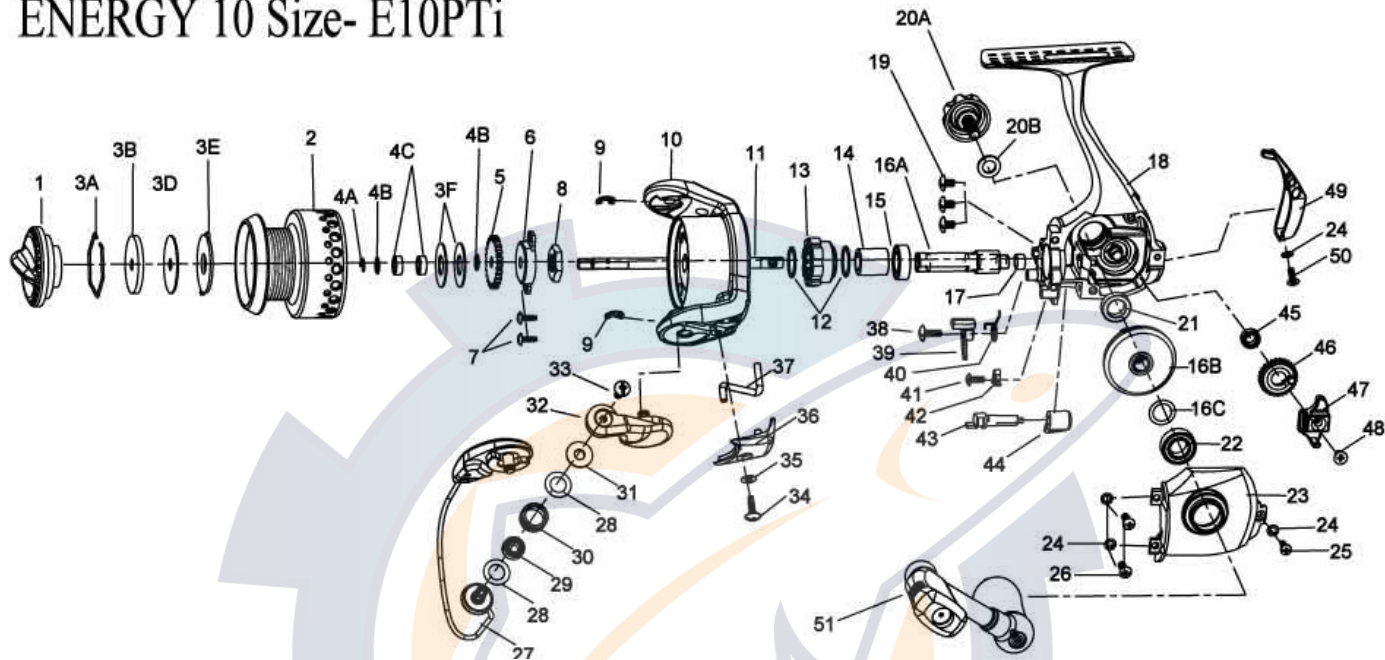

ENERGY 10 Size- E10PTi



| KEY # | DESCRIPTION                          | PART NO.         |
|-------|--------------------------------------|------------------|
| 1     | DRAG KNOB ASSEMBLY                   | PT332-10         |
| 2     | <b>SPOOL ASSEMBLY KIT</b>            | <b>PT4321-01</b> |
|       | 2-SPOOL ASSEMBLY                     |                  |
|       | 3-DRAG ASSEMBLY KIT                  |                  |
| 3     | <b>DRAG WASHER KIT</b>               | <b>PT4381-01</b> |
|       | 3A-DRAG RETAINER                     |                  |
|       | 3B-DRAG WASHER - CERAMIC             |                  |
|       | 3C-DRAG WASHER - KEYED TO MAIN SHAFT | N/A              |
|       | 3D-DRAG WASHER - FIBER               |                  |
|       | 3E-DRAG WASHER - KEYED TO SPOOL      |                  |
|       | 3F - DRAG WASHER - CLICK GEAR        |                  |
| 4     | <b>SPOOL BEARING KIT</b>             | <b>PT4371-01</b> |
|       | 4A-SPOOL BEARING CLIP                |                  |
|       | 4B- SPOOL BEARING WASHER "A"         | QTY 2            |
|       | 4C-SPOOL BEARING                     |                  |
|       | 4D-SPOOL BEARING WASHER "B"          | N/A              |
| 5     | CLICK GEAR                           | RQ037-01         |
| 6     | MAIN SHAFT BUSHING                   | RQ214-01         |
| 7     | ROTOR NUT LOCK SCREW                 | RQ094-01         |
| 8     | ROTOR NUT                            | SH006-01         |
| 9     | E-CLIP                               | GH034-01         |
| 10    | ROTOR ASSEMBLY                       | PQ309-55         |
| 11    | MAIN SHAFT                           | PT015-01         |
| 12    | CLUTCH WASHER                        | RQ167-01         |
| 13    | CLUTCH ASSEMBLY                      | RQ360-01         |
| 14    | CLUTCH SLEEVE                        | RQ139-01         |
| 15    | PINION BALL BEARING                  | CH028-10         |
| 16    | <b>GEAR ASSEMBLY KIT</b>             | <b>PT4011-01</b> |
|       | 16A-PINION                           |                  |
|       | 16B-DRIVE GEAR ASSEMBLY              |                  |
|       | 16C-ADJUST WASHER                    |                  |
|       | 17-PINION BUSHING                    |                  |
| 17    | PINION BUSHING                       | PQ141-01         |
| 18    | BODY                                 | PT001-01         |
| 19    | BEARING SCREW                        | RQ041-01         |

| KEY # | DESCRIPTION                   | PART NO.         |
|-------|-------------------------------|------------------|
| 20    | <b>HANDLE CAP SCREW KIT</b>   | <b>RQ4073-01</b> |
|       | 20A-HANDLE CAP SCREW          |                  |
|       | 20B-HANDLE SCREW WASHER       |                  |
| 21    | GEAR SHAFT BALL BEARING       | CH027-01         |
| 22    | GEAR SHAFT BALL BEARING       | CH028-01         |
| 23    | BODY COVER                    | PQ023-55         |
| 24    | BODY COVER SCREW WASHER       | RQ142-01         |
| 25    | BODY COVER SCREW              | SQ057-01         |
| 26    | BODY COVER SCREW              | PQ057-01         |
| 27    | BAIL ASSEMBLY                 | PQ347-51         |
| 28    | LINE ROLLER WASHER            | PQ102-51         |
| 29    | LINE ROLLER BALL BEARING      | GH202-01         |
| 30    | LINE ROLLER                   | PQ004-51         |
| 31    | LINE ROLLER COLLAR            | PQ102-01         |
| 32    | ARM LEVER ASSEMBLY            | PQ307-01         |
| 33    | LINE SLIDER SCREW             | AQ108-07         |
| 34    | ARM LEVER COVER SCREW         | GU077-15         |
| 35    | ARM LEVER COVER WASHER        | SQ142-01         |
| 36    | ARM LEVER COVER               | PQ087-01         |
| 37    | KICK LEVER                    | PQ019-01         |
| 38    | ANTI-REVERSE PAWL SCREW       | RQ077-01         |
| 39    | ANTI-REVERSE PAWL             | PQ063-01         |
| 40    | ANTI-REVERSE PAWL SPRING      | PQ061-01         |
| 41    | ANTI-REVERSE CAM SPRING SCREW | RQ062-01         |
| 42    | ANTI-REVERSE CAM SPRING       | PQ089-01         |
| 43    | ANTI-REVERSE CAM              | PT090-01         |
| 44    | ANTI-REVERSE LEVER            | RQ059-01         |
| 45    | O/S GEAR BALL BEARING         | EH158-01         |
| 46    | OSCILLATOR GEAR               | PQ053-51         |
| 47    | OSCILLATOR SLIDER             | PQ025-01         |
| 48    | MAIN SHAFT SCREW              | RQ100-01         |
| 49    | BODY REAR COVER               | PQ140-55         |
| 50    | BODY REAR COVER SCREW         | RQ062-02         |
| 51    | HANDLE ASSEMBLY               | PT318-51         |